

F3/ F3T/ F3L LEFT OR RIGHT BOTTLE HOLDER WITH OPTIONAL LED



Use the 80mm socket cap screw and insert it through the outside of the bottle holder, then insert spacer behind the holder through the bolt.



Apply Loctite liberally on the ends of the threads. Using 8mm allen socket, tighten the screw until snug.

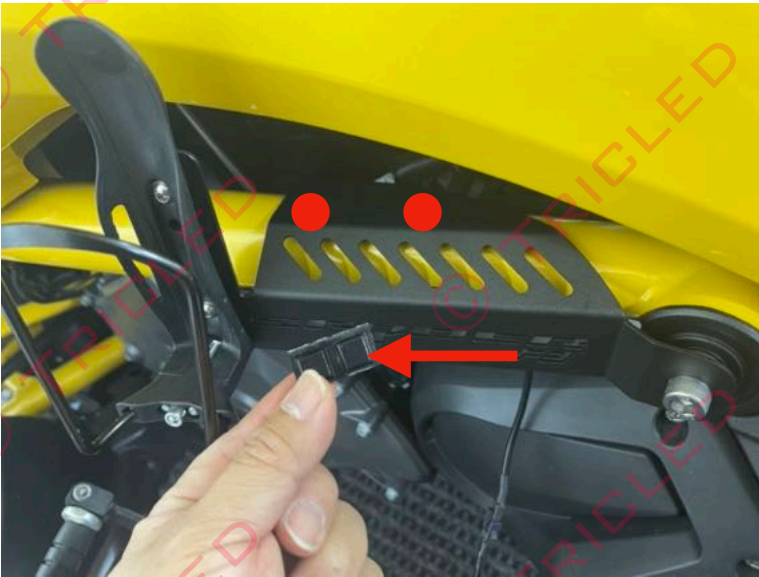

Use the two silicone square provided and apply it to the bottom side of the metal bracket marked with the red dot above to protect your frame.

F3/ F3T/ F3L LEFT OR RIGHT BOTTLE HOLDER WITH OPTIONAL LED

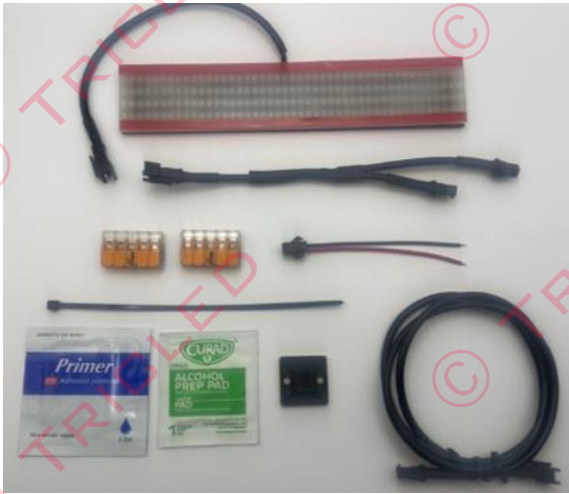

Installation for Add-on LED kit.

LEFT SHIFTER SIDE



Clean the back of the LED with alcohol wipe and let dry. Apply primer to the small area and adhere plastic zip tie square. Zip tie the wire.

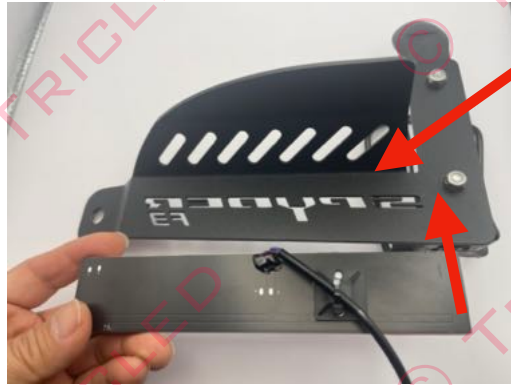

With the bottle holder back facing up, position the led board against the top and nylon insert nut. With wire to the top. See red arrows.

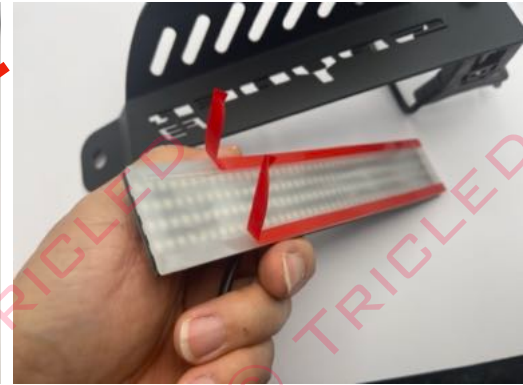

When you have the LED positioned, peel back the double sided adhesive and adhere it as shown on previous step.



Open the front trunk and remove the plastic service panel. Remove top side panel on the shifter side.



Remove the 2 torx 25 screws on the bottom side of the panel.



Remove the 2 side torx 25 bolt near the rear of the panel.

F3/ F3T/ F3L LEFT OR RIGHT BOTTLE HOLDER WITH OPTIONAL LED



Remove the 3 plastic push pins.



Cut the zip ties that holds the customer accessory wire

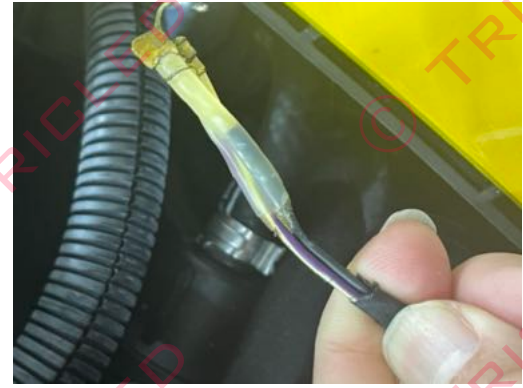

(Shown: accessory wire end covered from factory)



Cutoff the protective coating.

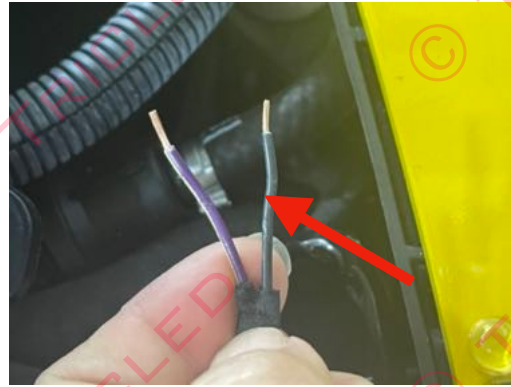

Strip the two wire ends. Black is ground wire. Colored wire is positive.

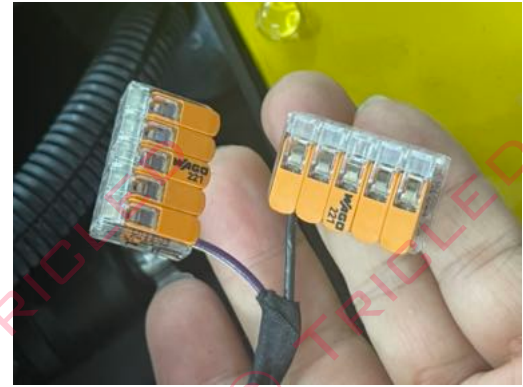

Use the lever locks, insert ground on one and positive on the other lever lock

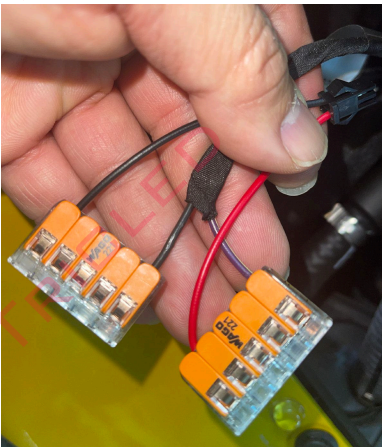

Attach the provided female connector. Black to black ground and red to positive

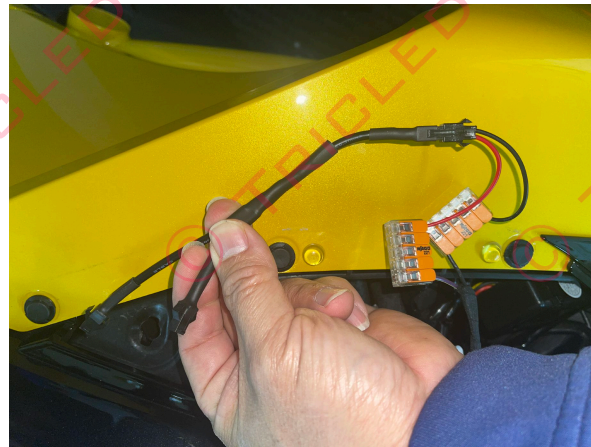

Attach the female connector to the 1:2 splitter provided. Then connect 12" extension to the left shifter side bottle LED

For the Right-throttle side bottle holder with LED, connect the 24" extension to that side and the other end to the open 1:2 splitter.

* If you purchase both sides, you will end up with extra parts and you can set these aside for future use.

F3/ F3T/ F3L LEFT OR RIGHT BOTTLE HOLDER WITH OPTIONAL LED

LEFT SIDE

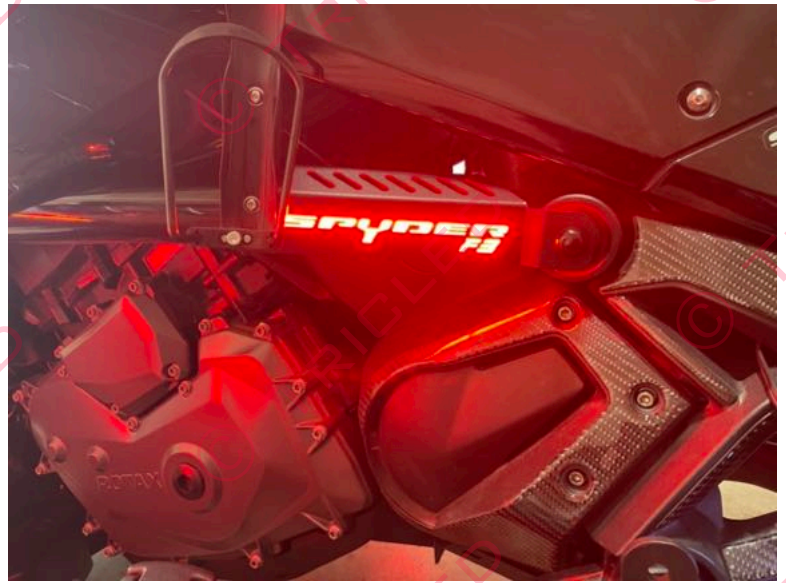

RIGHT SIDE

