

DOUBLE DIN IN-DASH INSTALLATION KIT FOR 2015-UP POLARIS SLINGSHOT

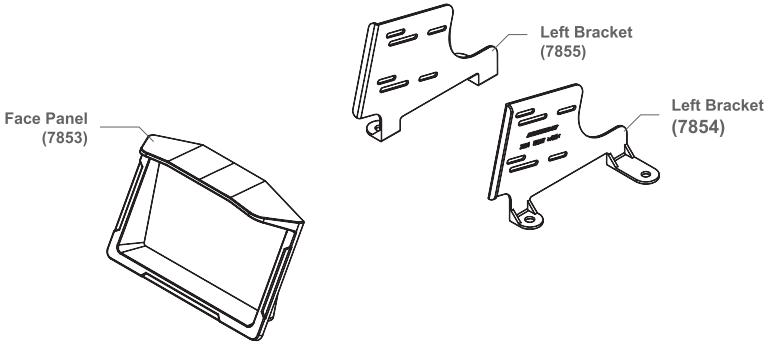

Designed & Engineered IN U.S.A.
Custom Manufactured in China

Tools Required:

- PRT Panel Removal Tool
- Screwdriver

INTRODUCTION/PRELIMINARY

This premium installation kit is for 2015-UP Polaris Slingshot vehicles. Included are all the parts you need to mount your car stereo or CD player into your vehicle's dash. Refer to individual instruction in this manual to remove your vehicle's factory radio and assemble the kit.

CAUTION: *DISCONNECT YOUR VEHICLE NEGATIVE BATTERY TERMINAL BEFORE THE INSTALLATION TO HELP PREVENT ELECTRICAL DAMAGE. WE RECOMMEND THE USE OF A VOLT/OHM METER OVER A TEST LIGHT TO CHECK WIRING. A TEST LIGHT OR GROUNDED WIRE PROBE CAN CAUSE DAMAGE TO THE VEHICLE'S COMPUTER AND/OR DIAGNOSTIC SYSTEMS. AVOID ALL FACTORY AIRBAG WIRING - AIRBAGS CAN ACCIDENTALLY DEPLOY CAUSING SERIOUS INJURY OR DEATH.*

NOTES

- See your vehicle's instructions for any special tools your installation might require.
- Read all instructions accompanying your car stereo for proper wiring and mounting instructions.

**STOP**

IMPORTANT!

DO NOT RETURN PRODUCT TO THE RETAILER

IF YOU NEED ASSISTANCE OR REPLACEMENT PARTS CALL US TOLL FREE: 1800-621-3695 X3

HOURS: MON-FRI 8AM-5:30PM (PST) SATURDAY 8AM-2PM (PST)

LIABILITY DISCLAIMER

This instruction booklet is based on carefully documented data and research of automobile disassembly, wire harness/codes and information pertaining to the installation of this kit. Scosche Industries, Inc. cannot be held responsible for discrepancies/inconsistencies that may occur due to the automobile manufacturing changes or options, or damages that may occur in the automobile during the installation of components while using this booklet.

For further questions, call our toll free technical help line: 1-800-621-3695 x3, or contact us on the web at www.scosche.com/contact

Step 1 *Disassembly*

Open the hood of the vehicle.

Note: Disassembly instructions are based on modified Slingshot with aftermarket windshield. Disassembly instructions may slightly vary per model.

**Step 2** *Disassembly*

- A. Remove (4) screws securing face panel trim.
- B. Remove the panel trim from location.

**Step 3** *Disassembly*

Unplug and remove the screen.

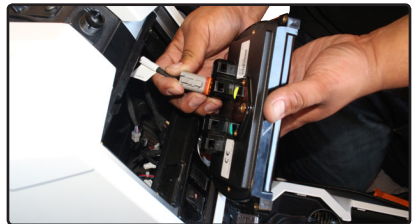
**Step 4** *Disassembly*

Pull-out and remove the mounting trim piece used to secure the radio screen and front face panel.



Step 5 *Disassembly*

Disconnect wiring connections located inside the of the dash cavity.

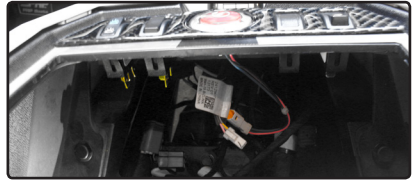
**Step 6** *Disassembly*

Using a panel removal tool carefully remove the two push pins located in cavity facing downward (retain for reassembly), see image at right.

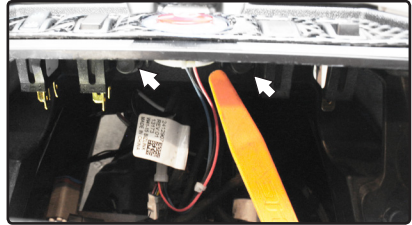
**Step 7** *Disassembly*

Use a panel removal tool remove the driver-side top center trim pieces located above the radio screen cavity.

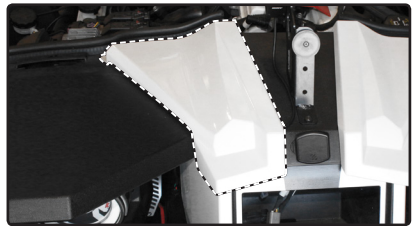
**Step 8** *Disassembly*

Remove the push pin exposed from previous step using a panel removal tool (retain for reassembly).

**Step 9** *Disassembly*

With a panel removal tool carefully unclip **(A)** the center console trim piece from back to front, and remove **(B)**.



Step 10 *Disassembly*

Repeat steps 7-9 on opposite side (retain all hardware for assembly).

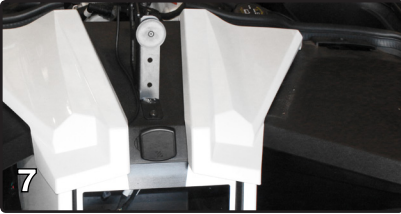
**Step 11** *Disassembly*

Remove the 14mm bolt securing the mirror to the vehicle, then repeat on the opposite side. Retain all hardware for assembly.

**Step 12** *Disassembly*

Open the glove-box located on the passenger side, and remove the (2) T-25 screws helping secure the top fender trim piece (See image for locations).

**Step 13** *Disassembly*

Using a panel removal tool carefully pry off the (2) push pins securing the lower portion of the side fender trim piece.



Step 14 *Disassembly*

Use a panel removal tool to carefully remove the fender trim piece loosened on previous 2 steps.

**Step 15** *Disassembly*

Repeat steps 11-14 on opposite side.



Note: Driver side does not have the glove-box (Step 12); however, the screw placement should mirror passenger side. Repeat image for step 12 is not shown in sample images.

**Step 16** *Disassembly*

Remove the screws securing the windshield in-place. Screw locations mirrored on opposite side.

Circles represent vehicle with aftermarket windshield (repeat on opposite side).

Arrows indicate OEM windshield locations (repeat on opposite side).

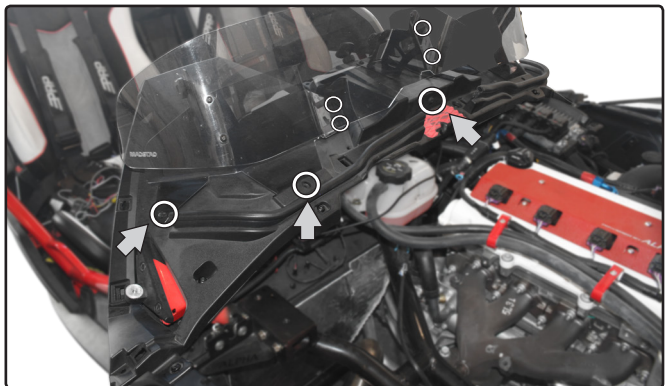

Step 17 *Disassembly*

Remove the (8) T-40 screws securing the top dash in-place, locations below.

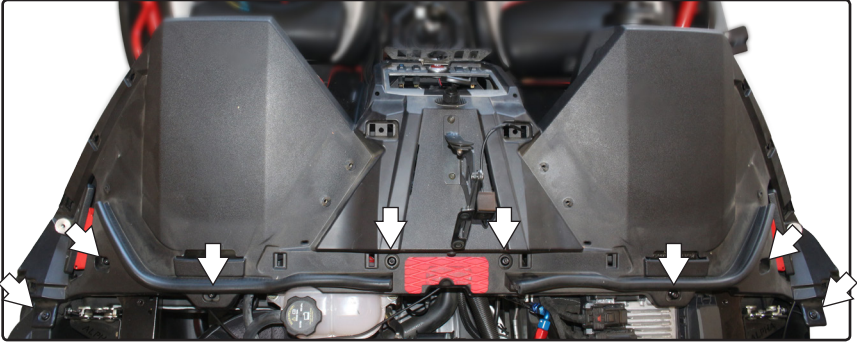
**Step 18** *Disassembly*

Lift and set aside the top dash for re install.

**Step 19** *Disassembly*

Remove the (2) T-40 screws in dash cavity (top arrows). Then remove the (2) push-pins using a panel removal tool (bottom arrows).

Note: Retain hardware for assembly.

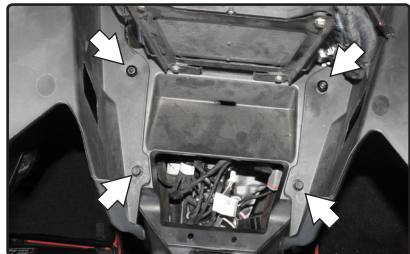

Step 1 *Assembly*

Adjust and mount the screws that were supplied with your aftermarket radio to the Scosche brackets provided.

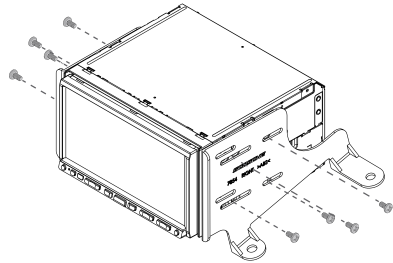
**Step 2** *Assembly*

Set the stereo assembly into the dash cavity then secure it using the two front push pins and rear (2) T-40 screws.

Note: Arrows indicate radio assembly mounting locations.

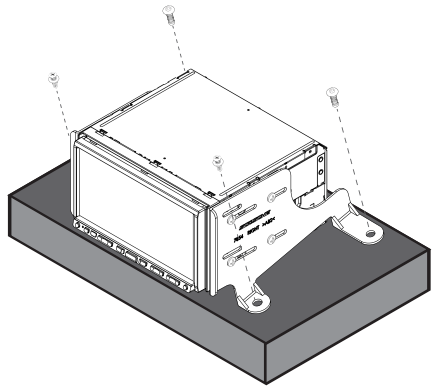
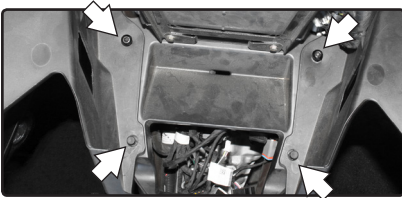
**Step 3** *Assembly*

Slide and snap the panel into the vehicles radio dash opening.

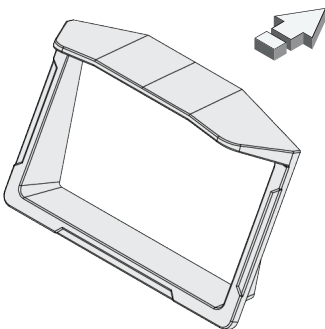
**Step 4**

Reassemble and make all the proper wiring connections in reverse order of the disassembly to complete installation.

