

CAN-AM RYKER LED USA Flag Mounting Plate Installation Instructions

****Please read thoroughly before proceeding with installation in order to ensure proper fit & functionality****

TOOLS NEEDED:

T25 torx screwdriver
T30 torx screwdriver
Phillips screwdriver
Plastic pry tool
Die-electric grease

PARTS LIST:

(1) aluminum mounting plate

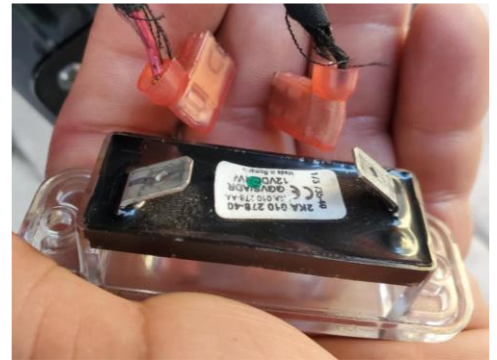
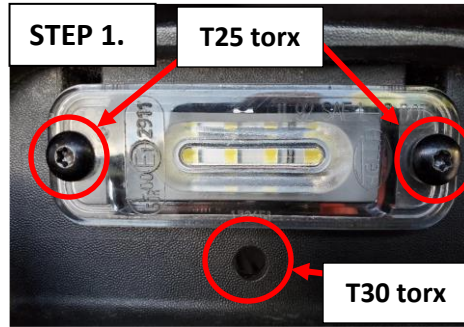

STEP 1. Begin by using a T25 torx screwdriver to remove the 2 torx screws from the license plate LED located under the front lip of the rear fender trim cover then remove the T30 torx screw.

Disconnect the positive & negative female connectors from the OEM LED male connectors.

Carefully remove the rear fender trim cover by gently pulling up & towards you slowly. A small pry tool may need to be used. Do not force the cover off, doing so may damage the wire harness that connects to the OEM license plate light connectors and will not be covered under the warranty.

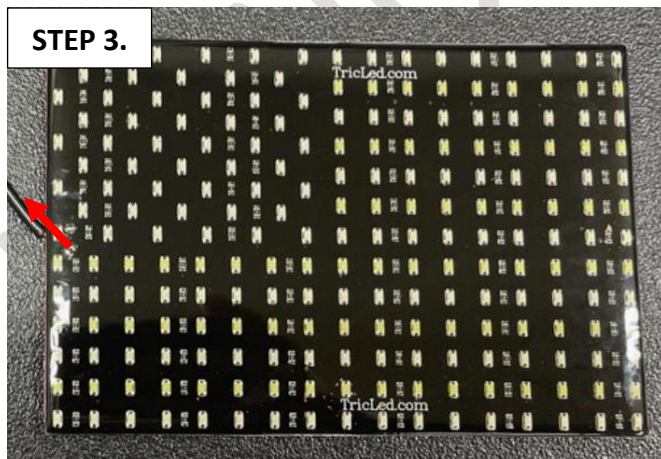
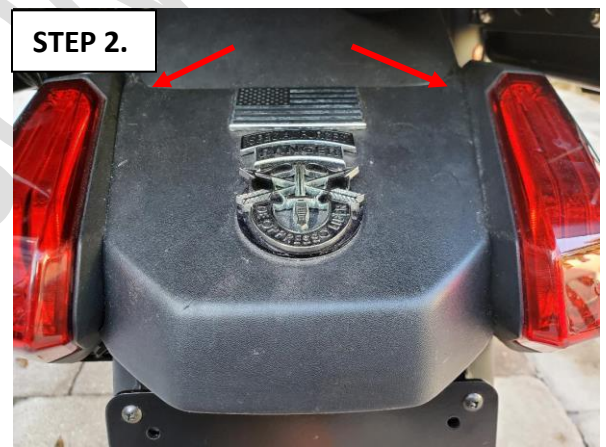

Next you will route the 2-pin female connector from the end of the wires coming off of the LED USA flag and route it through the hole in the RYKER mounting plate.

STEP 4.



Before peeling off the red 3M plastic from the back of the LED USA flag, make sure the surface of the mounting plate is cleaned & prepped with the alcohol & adhesive pads provided. Wipe the surface of the plate with the alcohol pad, let the alcohol dry, then wipe the area with the adhesive promoter pad and let dry.

Make sure that the LED USA flag is centered before laying it in on the aluminum RYKER plate. Once the LED USA flag is in place, gently press down on the LED USA flag to make sure that the entire surface has adhered to the plate.

[m1][m2][m3][m4][m5]

STEP 5.

(1) Locate the 2-pin male connector that is under the rear fender trim cover that you removed in **STEP 1**.

(2) Connect the 2-pin female connector from the LED USA flag to the 2-pin male connector.

(3) Before securing the plate to your Ryker, make sure that the wire leading from the LED USA flag and the connector are properly routed behind the mounting plate and the front of the rear fender so not to have them pinched once the plate is secured in place.

Take the 4 screws provided & align the holes on the plate with the mounting holes on the rear fender.

HAND TIGHTEN the screws with a Phillips screwdriver..**DO NOT OVERTIGHTEN**



2 pin male connector from

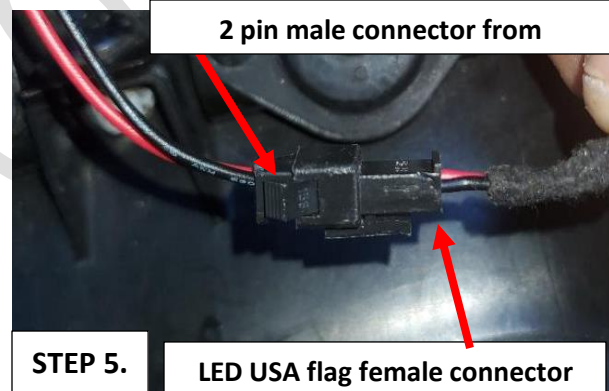

STEP 5.

LED USA flag female connector

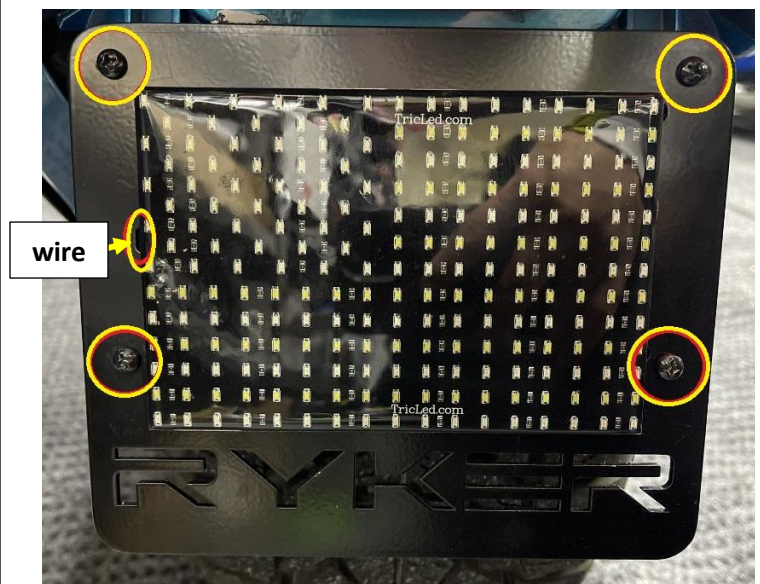

wire

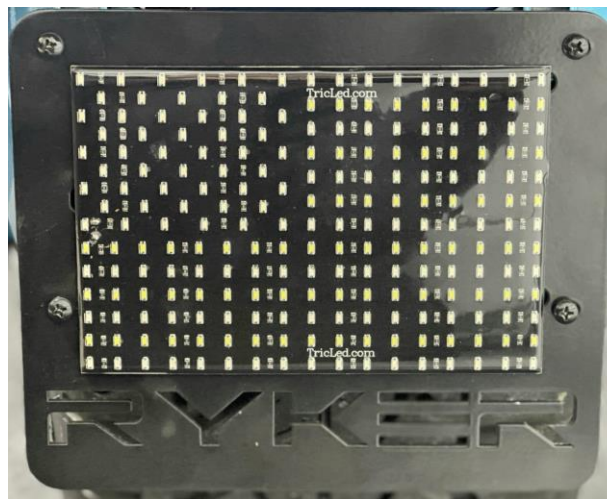
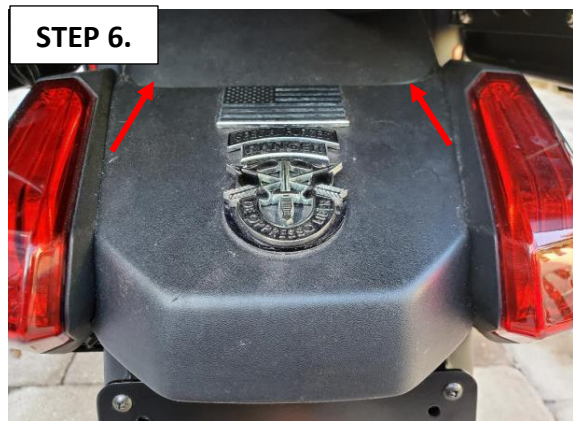

STEP 6. Now that your new LED USA flag is mounted and connected, re-assemble the OEM LED license plate light that you removed in **STEP 1**.

Make sure that all the wires are neatly zip tied together before re-installing the fender trim cover that you removed in **STEP 2**.

Once you have carefully re-installed the fender trim cover, push the START button on your RYKER.

The LED USA flag should illuminate vividly!

Hypnotic Concepts LLC * info@hypnotic-concepts.com * 813-658-5774