

Passenger Armrests for Can-Am Spyder F3

BEFORE YOU BEGIN

Read these instructions and check to be sure all parts and tools are accounted for. Please retain these installation instructions for future reference.

IMPORTANT

The Passenger Armrests Kit is exclusively designed for your vehicle. Please read the installation instructions thoroughly before beginning. Installation is easier if the vehicle is clean and free of debris. For your safety, and to ensure a satisfactory installation, perform all installation steps correctly in the sequence shown.

INSTRUCTIONS

PARTS LIST

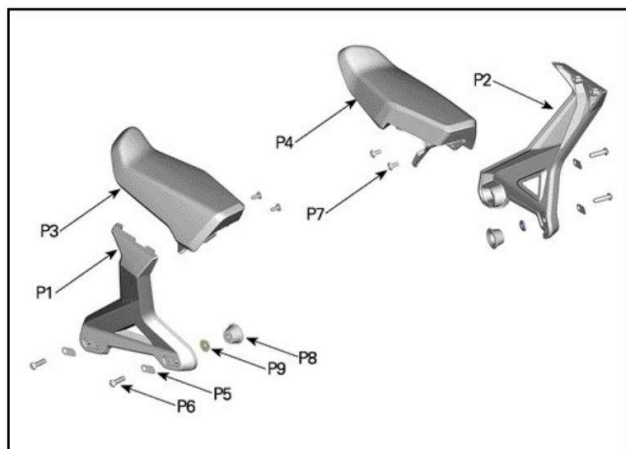

ITEM	DESCRIPTION	part number	qty
P1	Painted LH Armrest Support	Not Available Separately	1
P2	Painted RH Armrest Support	Not Available Separately	1
P3	LH Armrest Assembly	Not Available Separately	1
	LH Locking Lever	708002416	1
	Torx Truss screw M6 X 50	250000749	1
	Flanged Elastic nut M6	233261466	1
	Bushing	707001376	1
P4	RH Armrest Assembly	Not Available Separately	1
	RH Locking Lever	708002418	1
	Torx Truss screw M6 X 50	250000749	1
	Flanged Elastic nut M6	233261466	1
	Bushing	707001376	1
P5	Plate	708002405	4
P6	Torx Truss screw M8 X 30	250000733	4
P7	Torx Truss screw M6 X 16	250000348	4
P8	Sleeve	708002406	2
P9	Washer (with Top-Case)	708002639	2

INSTALLATION INSTRUCTIONS

1. Shift vehicle transmission into "PARK". Turn key to "OFF" position and remove from vehicle.
2. When installing with passenger backrest, use the sleeve [P8].

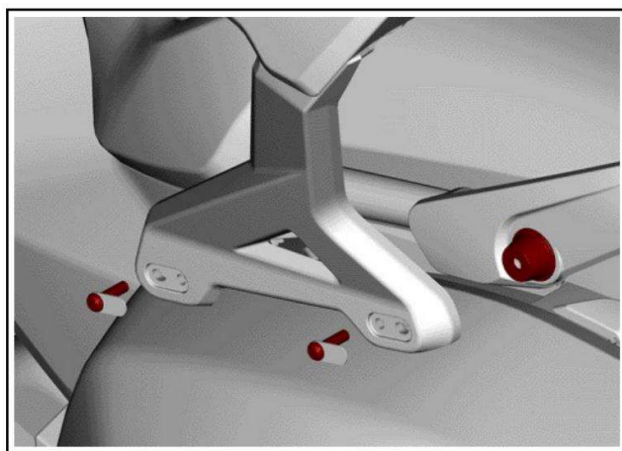

3. When installing with top case, use the washer [P9].

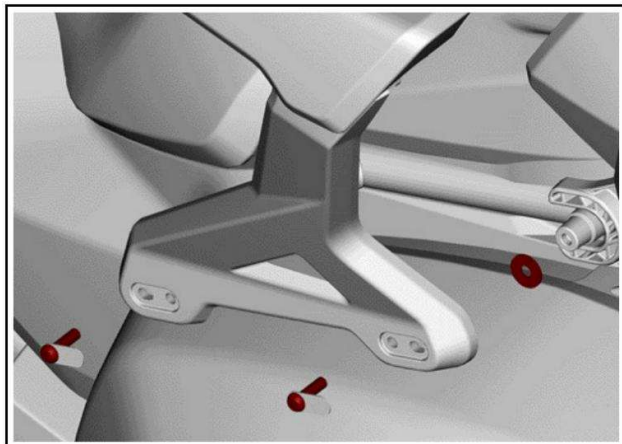

4. Start by pre-assembling the armrest support [P1] and armrest assembly [P3] utilizing the [P7] Torx truss screw M6 X 16.

Passenger Armrests for Can-Am Spyder F3

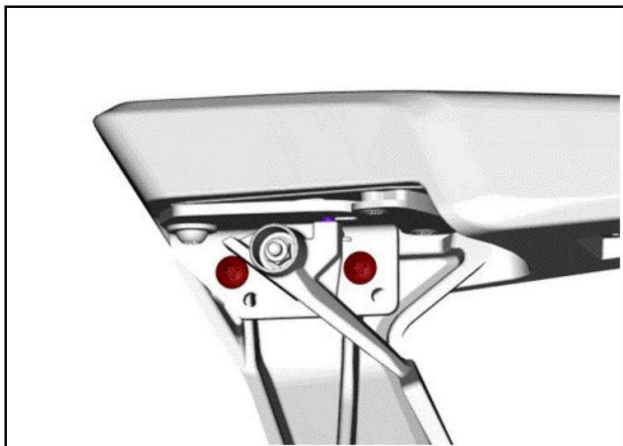

5. Install the assembled armrest using [P6] Torx truss screw M8 X 30 screws and plate [P5].

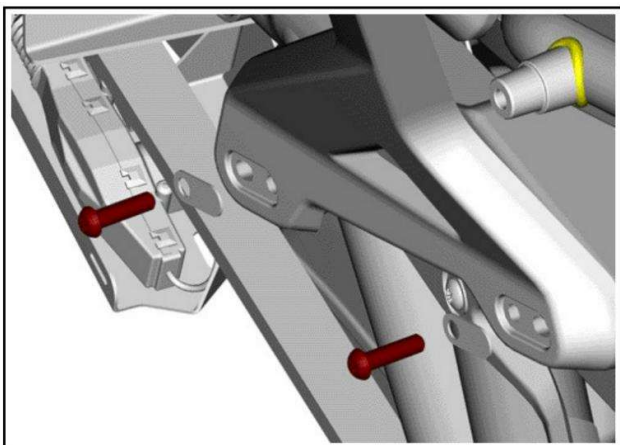

6. For maximum comfort, it is possible to adjust the position of the armrest in both front/back and up/down positions.

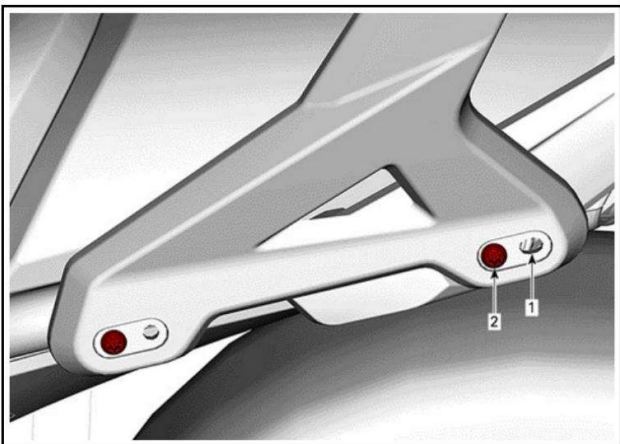

1. Front Position
2. Back Position

7. When changing position, flip plate [P5] upside

down.

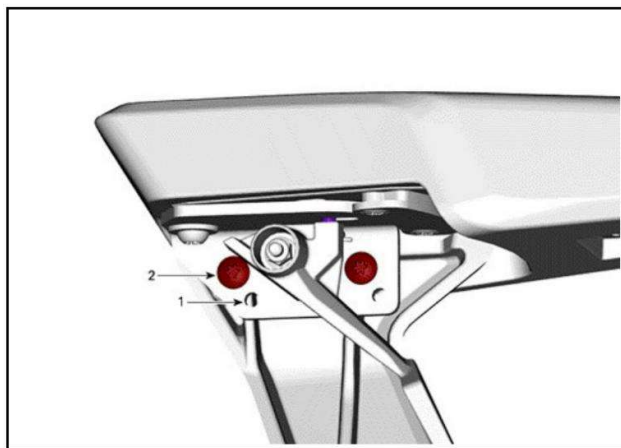

1. Upper Position
2. Lower Position

8. Use the locking lever to turn inside or outside the armrest.

