



## DXU1100DVR QUICK START GUIDE

This Quick Start Guide gives you the basic information to start using your DXU1100DVR. Please call customer service at 1-844-NAVATLAS, 1-844-628-2852

# NavAtlas™

Customer Service Toll Free: 1-844-628-2852

### Wiring Diagram - Inputs/Outputs

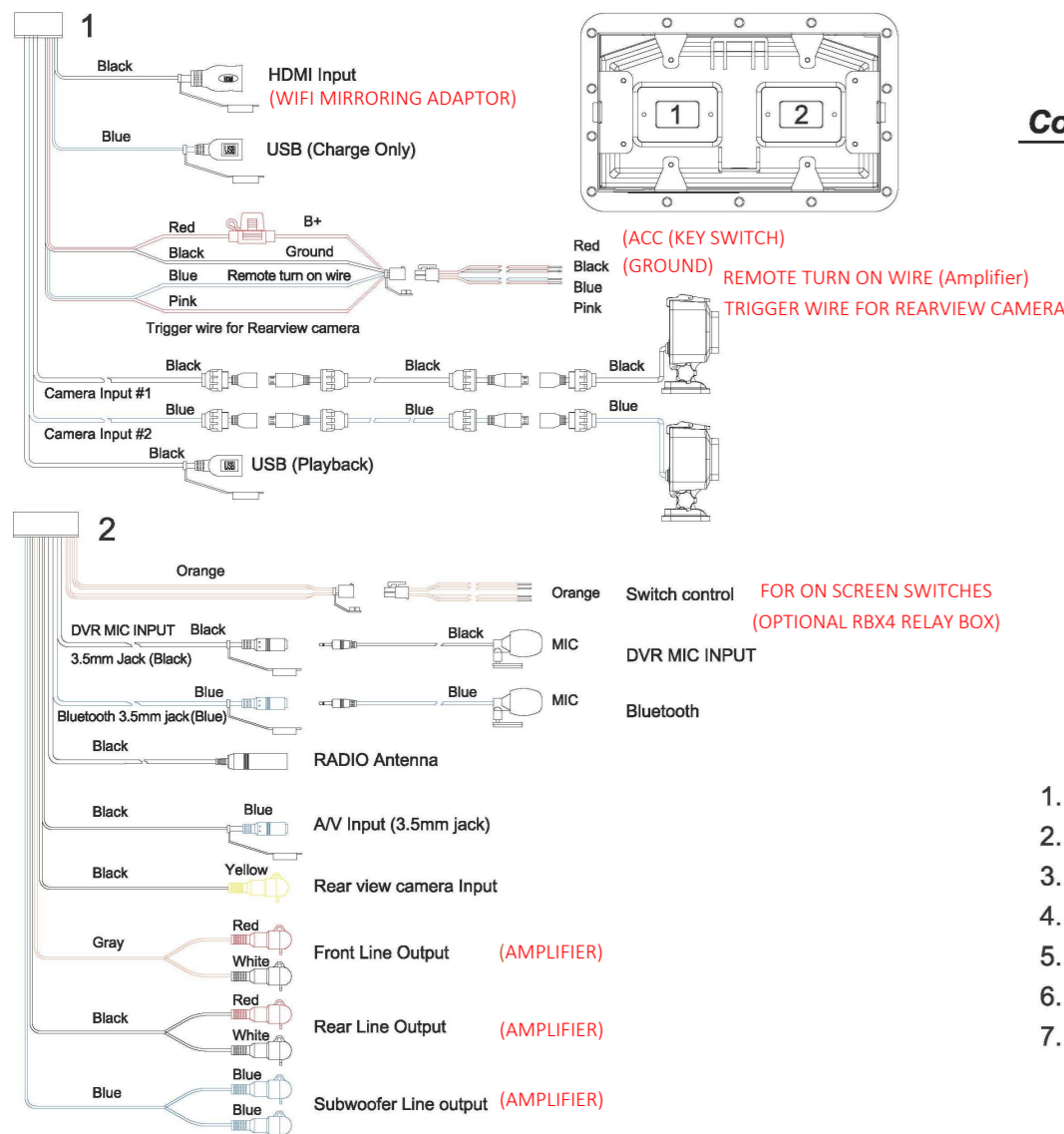

### Installation

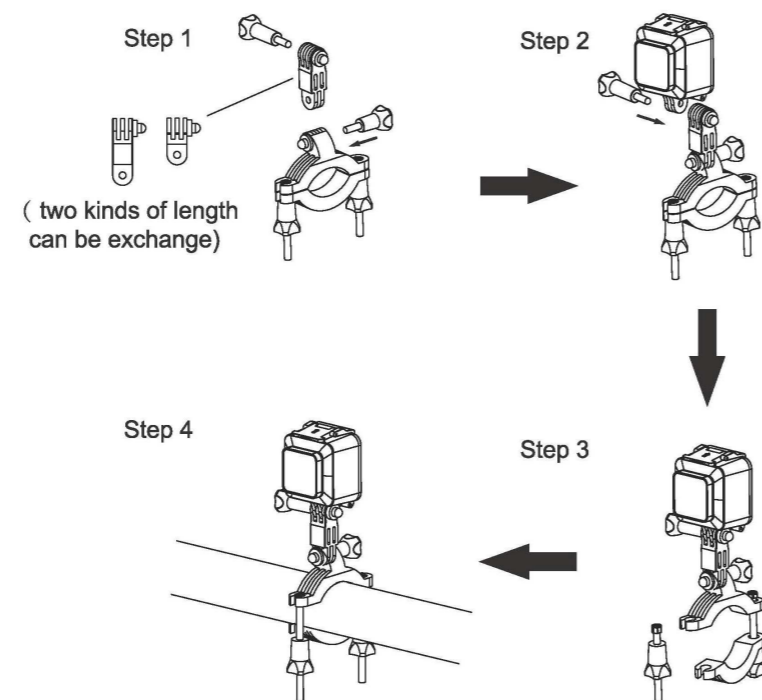
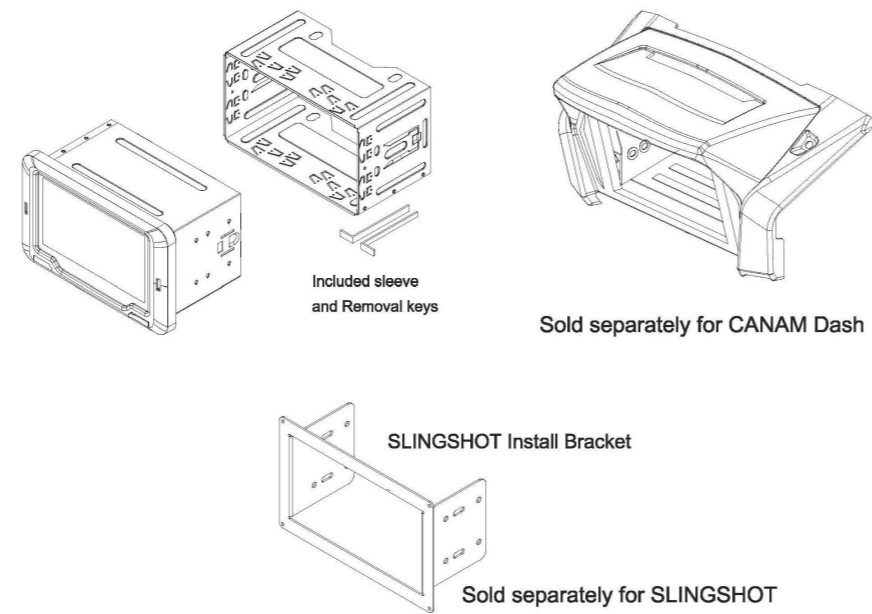

### Control Locations



1. Power/Mode: (long press for power on/off, short press changes source)
2. Home: Source select menu
3. VOL-: Decreases volume
4. VOL+: Increases volume
5. Return: Back button for DualMirror two way control (Android phone only)
6. Home: Home button for DualMirror two way control (Android phone only)
7. Menu: Menu button for DualMirror two way control (Android phone only)

### Home Screen

1. DVR
2. FM/AM Radio
3. USB
4. DualMirror
5. BT Music
6. Next Page
7. BT Phone
8. Video Player
9. Music Player
10. Previous Page
11. Picture Viewer
12. Aux Power Switches
13. QR Code (DualMirror App)
14. AV Input
15. Settings Menu

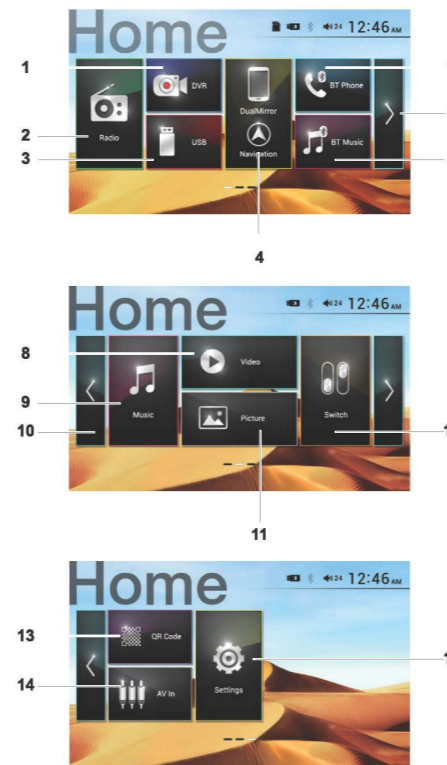

### Main Menu

In the Menu mode, press the desired icon to enter the corresponding mode: DVR, Tuner, USB, DualMirror, Bluetooth Phone, Bluetooth Music, A/V.

Tap LEFT or RIGHT arrows or Swipe to the left or right to get the next screen for more functions.

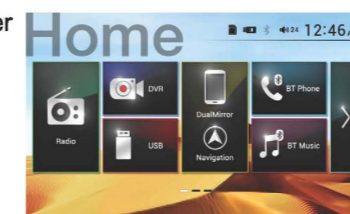

### Audio Control

Tap Audio Setting to select between Bass, Middle, Treble, Subwoofer, EQ, Loudness, Fader/Balance, Audio Mix.

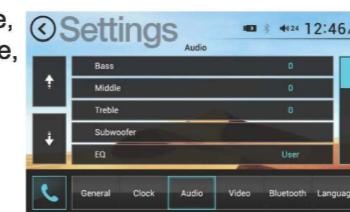

\*Audio Mix feature is designed to play Radio tuner audio while using the Dualmirror function for Navigation purposes only.

### Tuner Operation

Select the Tuner icon from the Main Menu screen or press MODE unit Tuner is selected.

1. Information Display
2. Return to Main Menu
3. Tune Down
4. Previous Menu
5. Mute On/Off
6. Audio Control
7. AS/PS
8. Band
9. Next Menu
10. Tune Up



### DVR Operation

Micro SD Card: For best recording quality, please use Class 10 type TF Card. Supports up to 2 TB.

Press DVR 1/DVR 2 TO Make Full Screen, Press screen while in full screen mode to return to normal view.

1. Scroll Up
2. Scroll Down
3. To enter BT Phone
4. Record video, press again while Recording to stop
5. View recorded videos
6. Enter DVR Settings
7. Delete Video

\* In case of camera image not showing or a distorted image, on installation before powering the unit, make sure both cameras are connected properly or you may experience these issues.

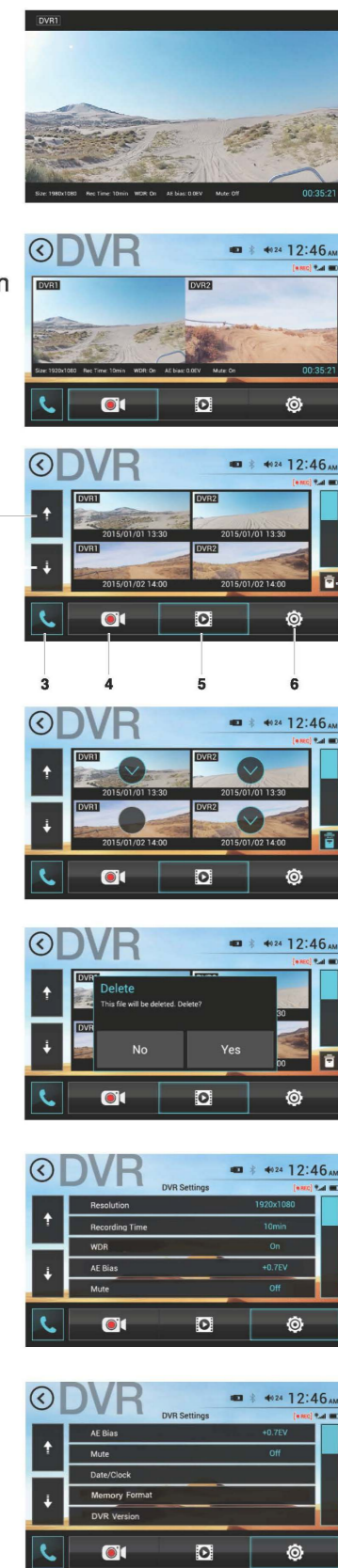

### Resolution

Set the video resolution 1920X1080/1280X720

### Recording Time

Sets the video time 1min/ 5min/ 10min/ continuous

### WDR

Wide Dynamic Range Can be set on or off

### AE Bias

Auto exposure setting Mute

Set up the recording sound on or off

### Date/Clock

Set the DVR time

### Memory Format

Erase the contents of the TF card

### DVR Version

DVR software version number

## USB Operation

1. Previous Page
2. Mute
3. Audio Control
4. Repeat
5. Random
6. Next Page
7. REW
8. FF
9. Loud
10. Subwoofer
11. AF
12. TA
13. UP
14. DOWN
15. USB File/Folder View

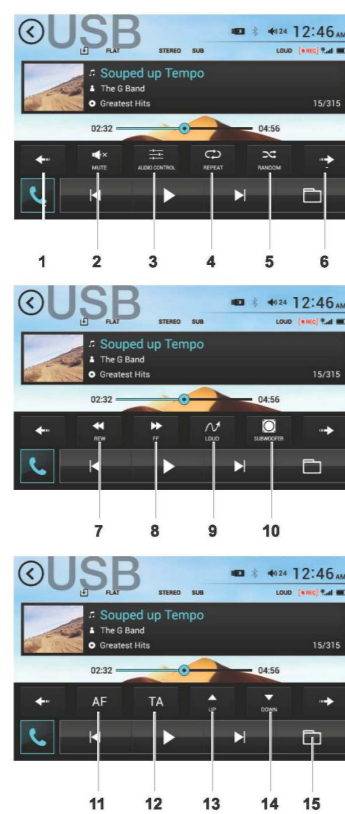

## AV In Operation

1. Previous Page
2. Mute
3. Audio Control
4. Loud
5. Subwoofer
6. Previous Page
7. AF
8. TA
9. UP
10. Down

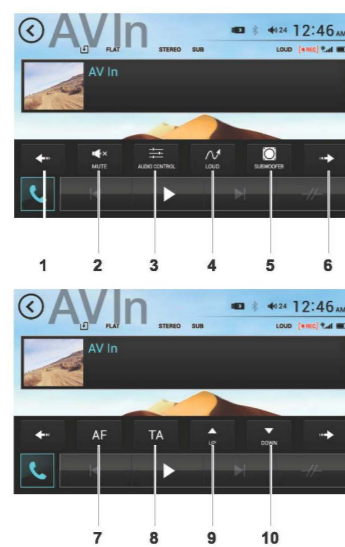

## BT Phone & BT MUSIC Operation

### Bluetooth Microphone

An external microphone can be mounted in an area close to the driver for better clarity.

### Pairing and Connecting

Before you can use a Bluetooth device, it must be paired and connected. The DXU1100DVR broadcasts the pairing signal constantly when no devices are currently connected. Complete the pairing sequence from your Bluetooth device. The device name is "NavAtlas-\*\*\*\*\*". The Bluetooth passcode "0000". Once pairing is complete, most Bluetooth device will connect automatically if the device is in range when the unit is powered-on.

### Dialing a Number

Press to display keypad and dial a number.

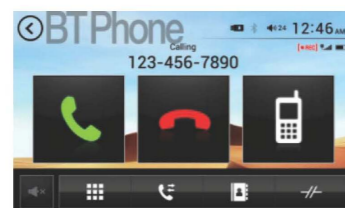

### Making and Ending a Call

Press to connect a call, and press to end a call.

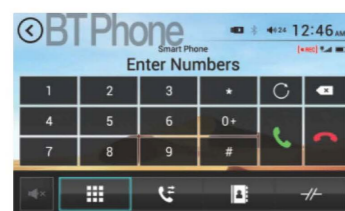

## BT Phone & BT MUSIC Operation

In order to access contacts, tap "Contact icon" You can reflash the contact list to tap "reflash icon"

### Accessing Recent Call List

Press to access the recent call list and view/select numbers from recent Received, Dialed or Missed calls

Search the paired BT devices

Tap "--/-" icon" to access the list of the paired BT devices. Select the desired device name to pair

### Streaming Audio

Press to enter the music control menu. Press to play or pause the music. Press to skip to the previous track. Press to advance to the next track.

## Switch Operation

Switch 1-4 provide a triggered 12V output for external lighting and other accessories, these triggers are meant to be used with 12V relays

NOTE: wires provide 1A of power only

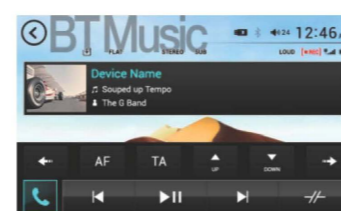
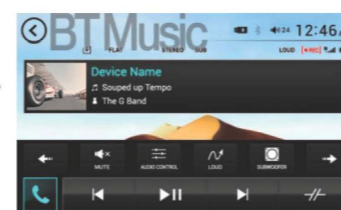
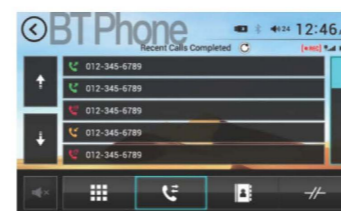
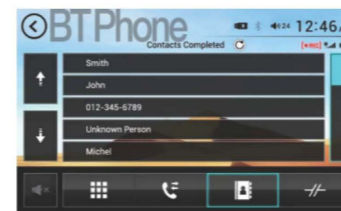

## DualMirror Operation

The DualMirror technology allows you to mirror The screen of select android phones as well as iPhone, iPad or iPod devices onto the receivers screen for viewing navigation or other apps.

### DualMirror or Screen Mirroring

1. Click QR code icon on HOME screen on page 3.
2. When QR code shows up, scan the QR code on the Android phone.
3. Download DualMirror.apk from Google Play Store.
4. When the download is complete, the DualMirror APP icon is created on main menu.
5. Select DualMirror App installed in the Android phone.
6. Tap OPEN BT SETTING to move to Bluetooth setting mode
7. Pair the Android phone with the DXU1100DVR unit via Bluetooth.

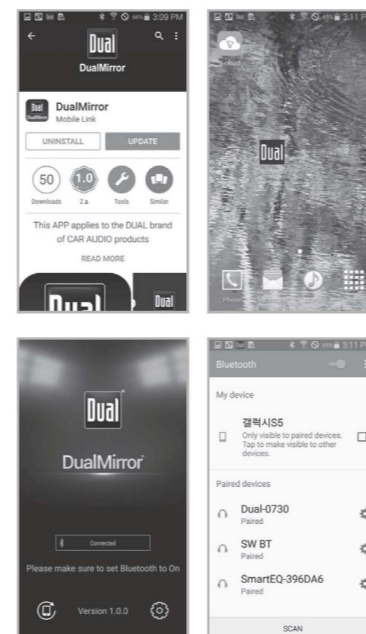

## DualMirror Operation

8. Connect Android phone to the DXU1100DVR using screen mirroring, MHL or HDMI inputs.
9. Select DualMirror Mode.
10. Tap ACCEPT on Warning screen.

### Remark:

If 2 way control does not work, check if DualMirror APK works or Bluetooth is paired or not.

Bluetooth will not automatically pair (reconnect) when the unit is powered off while in DualMirror Mode, when the unit restarts in DualMirror mode the Bluetooth must be manually reconnected via the DualMirror app.

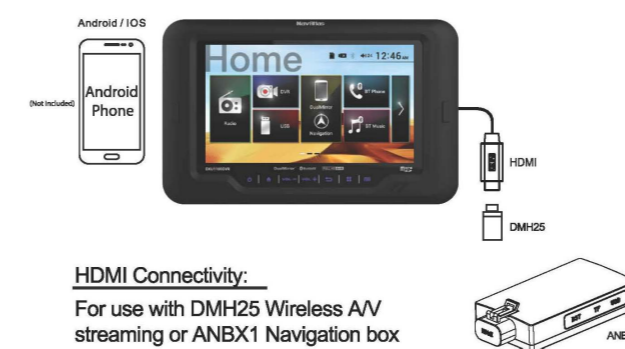

### HDMI Connectivity:

For use with DMH25 Wireless AV streaming or ANBX1 Navigation box

## QR Code Operation



### Copyright and Trademark Notes

This product incorporates copyright protection technology that is protected by method claims of certain U.S. patents and other intellectual property rights owned by Macrovision Corporation and other rights owners. Use of this copyright protection technology must be authorized by Macrovision Corporation, and is intended for home and other limited viewing uses only unless otherwise authorized by Macrovision Corporation. Reverse engineering or disassembly is prohibited. Manufactured under license from Dolby Laboratories. Dolby and the double-D symbol are trademarks of Dolby Laboratories. DVD Logo is a trademark of DVD Format/Logo Licensing Corporation registered in the U.S., Japan and other countries. SD Logo is a trademark of SD-3C, LLC. iPod and iPhone are trademarks of Apple Inc., registered in the U.S. and other countries. Dual Electronics Corporation is not affiliated with Apple, Inc. Other trademarks and trade names are those of their respective owners.

## FCC STATEMENT

This device complies with Part 15 of the FCC Rules. Operation is subject to the following two conditions:

- (1) This device may not cause harmful interference, and
- (2) This device must accept any interference received, including interference that may cause undesired operation.

### Warning :

Changes or modifications not expressly approved by the party responsible for compliance could void the user's authority to operate the equipment.

### NOTE :

This equipment has been tested and found to comply with the limits for a Class B digital device, pursuant to Part 15 of the FCC Rules. These limits are designed to provide reasonable protection against harmful interference in a residential installation. This equipment generates uses and can radiate radio frequency energy and, if not installed and used in accordance with the instructions, may cause harmful interference to radio communications. However, there is no guarantee that interference will not occur in a particular installation. If this equipment does cause harmful interference to radio or television reception, which can be determined by turning the equipment off and on, the user is encouraged to try to correct the interference by one or more of the following measures:

- ( 1 ) Reorient or relocate the receiving antenna.
- ( 2 ) Increase the separation between the equipment and receiver.
- ( 3 ) Connect the equipment into an outlet on a circuit different from that to which the receiver is connected.
- ( 4 ) Consult the dealer or an experienced radio/TV technician for help.

## FCC Radiation Exposure Statement

This equipment complies with FCC radiation exposure limits set forth for an uncontrolled environment. This equipment should be installed and operated with minimum distance 20cm between the radiator & your body.

FCC ID:2AF5L-DXP1000DVR

## One-Year Limited Warranty

This warranty gives you specific legal rights. You may also have other rights which vary from state to state.

Namsung America Corp. warrants this product to the original purchaser to be free from defects in material and workmanship for a period of one year from the date of the original purchase.

Namsung America Corp. agrees, at our option, during the warranty period, to repair any defect in material or workmanship or to furnish an equal new, renewed or comparable product (whichever is deemed necessary) in exchange without charges, subject to verification of the defect or malfunction and proof of the date of purchase. Subsequent replacement products are warranted for the balance of the original warranty period.

Who is covered? This warranty is extended to the original retail purchaser for products purchased from an authorized dealer and used in the U.S.A.

What is covered? This warranty covers all defects in material and workmanship in this product. The following are not covered: software, installation/removal costs, damage resulting from accident, misuse, abuse, neglect, product modification, improper installation, incorrect line voltage, unauthorized repair or failure to follow instructions supplied with the product, or damage occurring during return shipment of the product

### What to do?

1. Before you call for service, check the troubleshooting guide in your owner's manual. A slight adjustment of any custom controls may save you a service call.
2. If you require service during the warranty period, you must carefully pack the product (preferably in the original package) and ship it by prepaid transportation with a copy of the original receipt from the retailer to an authorized service center.
3. Please describe your problem in writing and include your name, a return UPS shipping address (P.O. Box not acceptable), and a daytime phone number with your shipment.
4. For more information and for the location of the nearest authorized service center please contact us:

• Call us toll-free at 1-844-NAVATLAS, 1-844-628-2852

Exclusion of Certain Damages: This warranty is exclusive and in lieu of any and all other warranties, expressed or implied, including without limitation the implied warranties of merchantability and fitness for a particular purpose and any obligation, liability, right, claim or remedy in contract or tort, whether or not arising from the company's negligence, actual or imputed. No person or representative is authorized to assume for the company any other liability in connection with the sale of this product. In no event shall the company be liable for indirect, incidental or consequential damages.