



SHOWCHROMEUSA.COM

1-888-244-2453



GOLD AURA TURN SIGNAL LIGHT

PRODUCT NUMBER: 44-112

INSTALLATION INSTRUCTIONS



RIDE WITH US!

Founded in 1981 and located in Northern Wisconsin, Show Chrome believes that everyone deserves convenience, safety, and style. All of our products are designed by riders for riders to achieve just that.

Our products are designed and engineered in the USA and 50% of our products are manufactured in the USA: your investment in us and our community.

Please let us know how we can make your ride even better. Our team of riders in Wisconsin answers every customer call Monday – Friday, 9am – 5pm Central Time.

Sincerely,
Your Show Chrome Team
Rice Lake, WI, USA

1 | INTRODUCTION

RIDE WITH

These instructions are for both riders and dealers – written as a step-by-step guide with an eye for detail, just like our products. It's all part of your experience with Show Chrome, and we take that seriously.

LET US KNOW!

Please review the instructions before diving in, and if things get uncomfortable, don't hesitate. Reach out to us. We're here to help and offer direct, human customer service based in Rice Lake, WI, USA – every time at 888-244-2453.

2 | THE DESIGNER



NOTE FROM THE DESIGNER

The Gold Aura Turn Signal Light keeps us safer. This light's design helps your ride look more stylish as well as it allows you to be seen by other drivers. And, it's designed with advanced, efficient LEDs to capture attention. Finally, I wanted this to be easy for you to install so you're back on the road faster.

I hope this light gives you more confidence and style on the road, and that you have as much fun driving with it as I had designing it!

Ride safely,

Jonathan Gustum
R&D Engineer, Show Chrome

3 | DETAILS & ACCESSORIES

PRODUCT INFO

Product: Gold Aura Turn Signal Light

Part Number: 44-122

Fitment: Polaris Slingshot 2015+

INCLUDED

Left Gold Aura Turn Signal Light (X1), Right Gold Aura Turn Signal Light (X1),

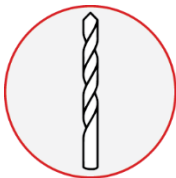
Sub-Harness (X1), Wire Tie (X6), Rubbing Alcohol Wipe (X1), Adhesive

Promoter Wipe (X1)

TOOLS NEEDED



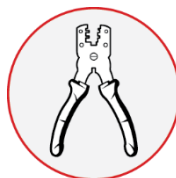
Drill



1/2" Drill Bit



Masking Tape

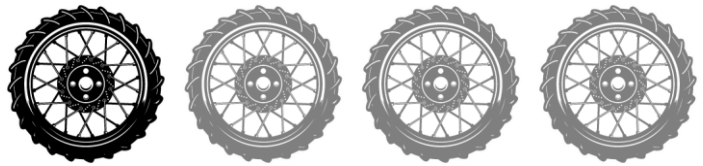


Side Cutter
Pliers

TIME TO INSTALL

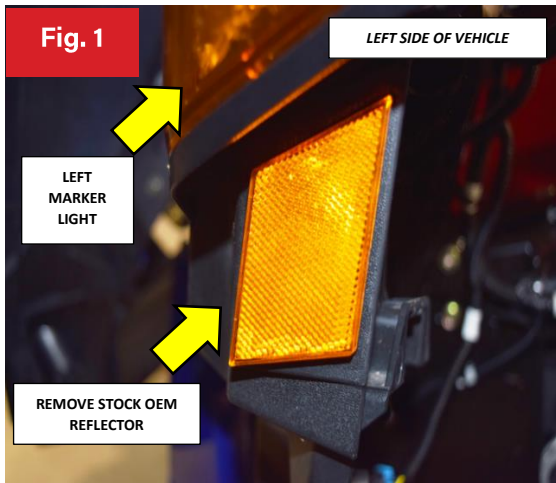


DIFFICULTY LEVEL



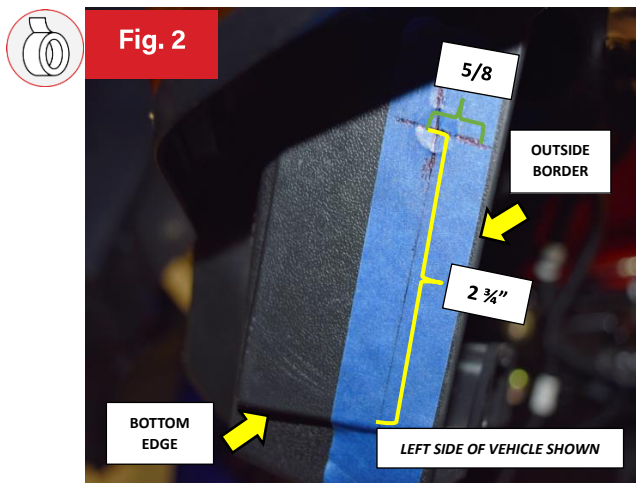
EASY

4 | INSTRUCTIONS

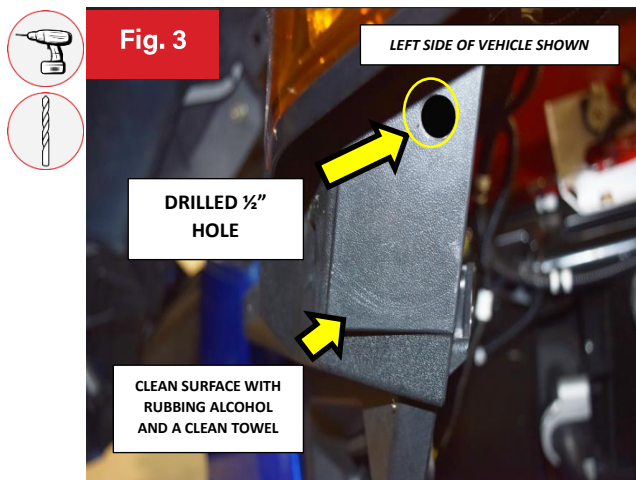


1. Let's start by opening the hood of the Slingshot.
2. Starting from driver's side, remove the stock OEM reflector. Reflector indicated in **FIG. 1**.

NOTE: At Show Chrome we recommend using fish line to easily remove stock OEM reflector.



3. Place a piece of MASKING TAPE as shown in **FIG. 2**.
2. Measure 2 3/4" from the bottom edge of the surface where the stock OEM reflector was mounted and place a vertical line perpendicular to the bottom edge. Measure 5/8" from the outside border and place a line parallel to the bottom edge. See (**FIG. 2**).
4. Hold the new Gold Aura Light up to the surface where it will be mounted to verify wiring lines up with corresponding marks on the surface before drilling.



5. Drill 1/2" hole through the surface centered on the mark made in step 3 (**FIG. 3**).

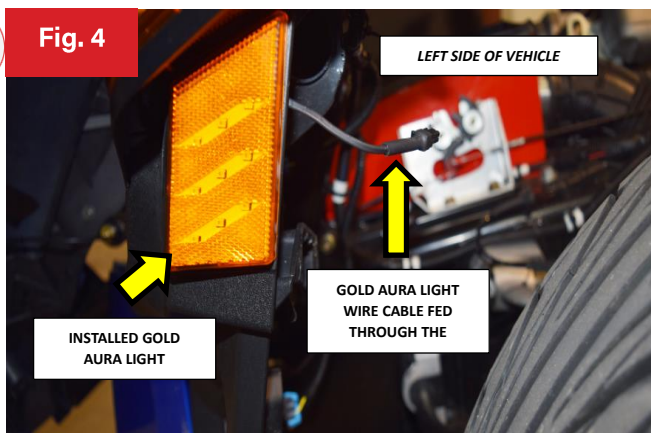
Remove the MASKING TAPE and any burs from drilling the hole.

NOTE: At Show Chrome we recommend using a Step Drill Bit or Brad Point Drill Bit for drilling plastic panels to avoid damaging the panel.



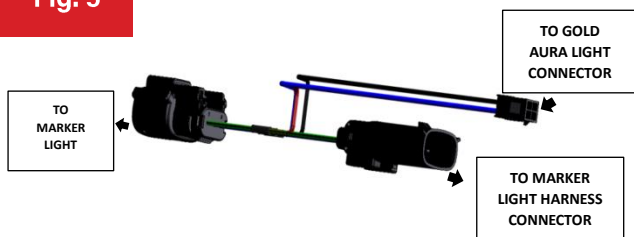


Fig. 4



6. Clean the surface where the Gold Aura Turn Signal Light will be mounted with RUBBING ALCOHOL WIPES and let surface dry completely before continuing.
7. Feed the end of the Gold Aura Turn Signal Light cable through the 1/2" hole and pull the slack.
8. Place the Gold Aura Light into position and align it to see how it will look before removing the backing tape.
9. When you're ready to install the Gold Aura Light, remove the backing tape from the Light and carefully press it into place on the surface after wiping the surface where the light will mount with the ADHESIVE PROMOTER WIPES provided (FIG. 4).

Fig. 5



10. Connect Sub-Harness according to FIG. 5.
11. Test light after installment to verify correct function.

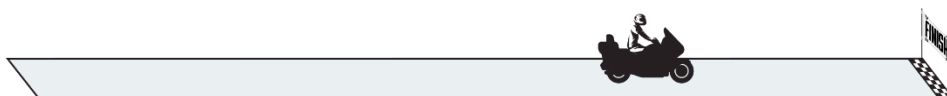
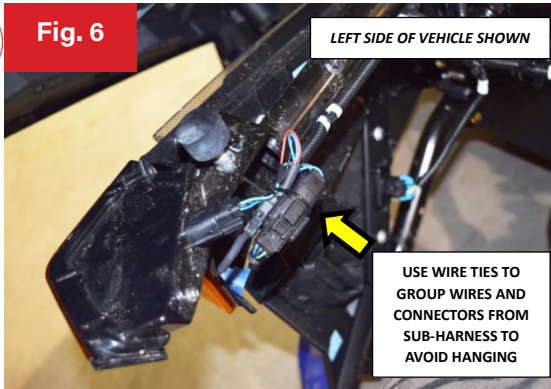




Fig. 6



12. Using the WIRE TIES provided, group the wires and connectors together to minimize wires from hanging (**FIG. 6**). Use SIDE CUTTER PLIERS to cut excess from WIRE TIES.

13. Repeat steps 2-13 on the passenger's side.

NOTICE

THIS IS AN ADHESIVE BACKED PRODUCT. CAUTION MUST BE TAKEN DURING INSTALLATION TO PROPERLY POSITION FOR ONE TIME PLACEMENT. REPEAT TRIALS WILL RESULT IN FAILURE OF ADHESIVE

NOTICE

IGNORING THE CONTENTS OF THESE INSTRUCTIONS MAY AFFECT THE PRODUCT PERFORMANCE AND FUNCTIONALITY. NOT FOLLOWING THESE INSTRUCTIONS MAY CAUSE DAMAGE TO THE PRODUCT OR THE VEHICLE TO WHICH IT IS BEING ATTACHED.

