

SLINGSHOT RGB KIT #3 INTERIOR

Kit #3 content:

Alcohol pad, primer

(4) 14" RGB strip

(1) 24" extension

(3) 63" extension

(4) 1:2 extension

(1) 1:6 splitter

What you will need.

1/4" plastic loom and zip ties

The interior kit is an add on to the existing system. The 4 RGB strips is placed from underneath these panels on diagram 1. Clean all surfaces with alcohol and apply primer before applying the strip. The RGB strip on the left and right side panels are installed with the extensions facing the rear, see diagram 2. You will run the wire back then under through the inside cabin. Use loom and zip ties as you work along the inside cabin and zip tie it to the frame area. See diagram 1, gray lines is where the wires are run.

The two strips in the very front is installed just above the foot-well with connectors facing towards the outside of the vehicle. In here you will attach the 1:2 splitter and connect it with the extension running from the side LED.

Once you've installed the 1:2 splitter on both sides and connected the rear extension, passenger side will use the 63" extension and run up through the firewall and over towards the front firewall in front of the driver, see diagram 3.

From driver side, run the 24" extension from the 1:2 splitter to the front of the driver side firewall in the engine bay, see diagram 3. You will unhook Kit #1 that goes into the remote. Connect kit #1 to the new 1:6 splitter and connect interior LED from passenger and driver side to the 1:6 splitter. Connect the 1:6 splitter into remote receiver. Now your entire system will be controlled with the same remote module.

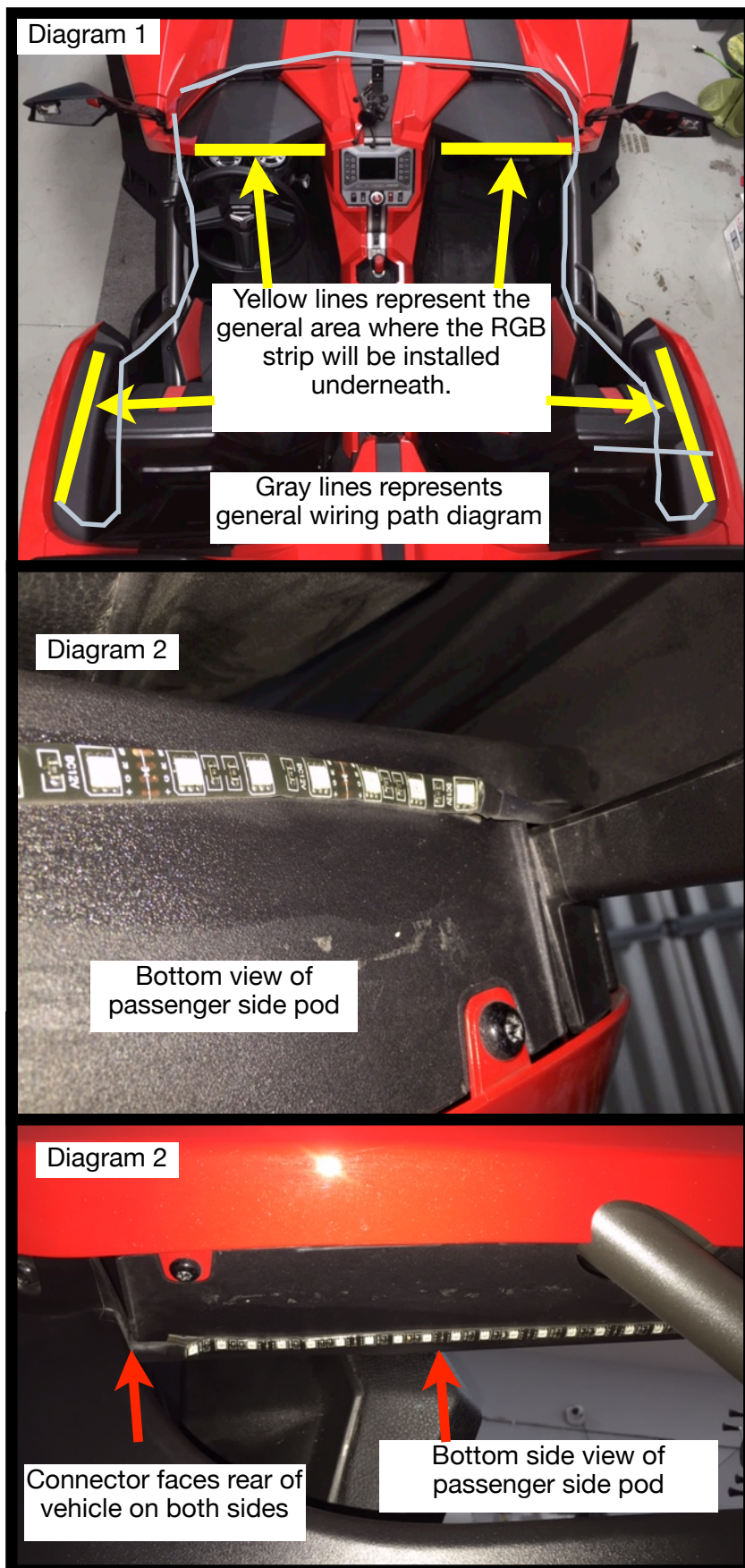

SLINGSHOT RGB KIT #3 INTERIOR

See illustrations on right for more
picture clarifications

